

# M42 Junction 6 Development Consent Order

**Scheme Number TR010027**

## **8.5 Record of engagement with Mr Philip O'Reilly**

Volume 8

June 2019

Infrastructure Planning

Planning Act 2008

**M42 Junction 6 Development Consent Order**  
Development Consent Order 202[ ]

---

**Record of engagement with Mr Philip O'Reilly**

---

<b>Regulation Number</b>	
<b>Planning Inspectorate Scheme Reference</b>	TR010027
<b>Document Reference</b>	8.5
<b>Author</b>	M42 Junction 6 Project Team

<b>Version</b>	<b>Date</b>	<b>Status of Version</b>
1	June 2019	Final

## **Table of contents**

<b>Table of contents</b>	<b>2</b>
<b>1 Introduction</b>	<b>3</b>
1.1 Purpose of this document	3
<b>2 Record of engagement with Mr O'Reilly</b>	<b>4</b>

# 1 Introduction

## 1.1 Purpose of this document

- 1.1.1 This document has been prepared in respect of the proposed M42 Junction 6 Development Consent Order (“the Application”) made by Highways England Company Limited (“Highways England”) to the Secretary of State for Transport (Secretary of State) for a Development Consent Order (“the Order”) under section 37 of the Planning Act 2008 (“PA 2008”).
- 1.1.2 Highways England and Mr Philip O’Reilly have been engaged in consultation and a record of engagement has been prepared in association with the DCO Examination for the M42 Junction 6.
- 1.1.3 This record of engagement has been prepared by Highways England following a request by The Examining Authority, at the Open Floor Hearing on 22<sup>nd</sup> May 2019.

## 2 Record of engagement with Mr O'Reilly

2.1.1 The parties have been engaged in consultation since the beginning of the proposed development. A summary of the meetings and correspondence that has taken place between Highways England and Mr O'Reilly of Four Winds in relation to the Application is outlined in Table 1.1.

**Table 1.1 Record of Engagement**

Date	Form of correspondence	Key topics discussed and key outcomes (the topics should align with the Issues tables)
12.12.17	Email	Circulation of the timetable to Mr O'Reilly for the upcoming consultation events for the Statutory Consultation between 9 Jan 2018- 31 Jan 2018. Highways England (HE) offered to arrange a specific appointment with members of the Project Team at one of the consultation events, if requested by Mr O'Reilly.
	Email	Mr O'Reilly requested clarification that all of the Project Team will be at both St. Peters Church Hall and Fentham Hall events, as those would be the most likely dates that he would be able to attend.
05.01.18	Email	Confirmation that HE land and compensation staff will be available at the two events that Mr O'Reilly queried in his email (12.12.17) and follow up email (04.01.18), in addition to the WGAA in Bickenhill on 27.01.18. HE offered Mr O'Reilly a separate meeting at his convenience to discuss the scheme and potential impacts on Four Winds.
09.01.18	Statutory Consultation	Commencement of statutory consultation and the publication of a Scheme layout plan (ref-HE551485-ACM-HGN-M42_SW_ZZ_ZZ-DR-CH-002). A copy of this plan can be found in Appendix B.
31.01.18	Email	Query regarding why Ardent are requesting ownership details of Four Winds, having previously submitted details in December 2017.
16.02.18	Email	Response from Ardent on behalf of HE in relation to Mr O'Reilly's query outlined in his email on 31.01.18. Explanation that the additional RFI that was sent to Mr O'Reilly was due to the need to ascertain whether there are any additional interests in the land/property that could be entitled to a compensation claim, but not subject to any potential land take. If there are no further interests in Four Winds, there is no requirement to return the second RFI to Ardent.

19.03.18	Phone call	Phone call from Mr O'Reilly requesting a progress update. It was explained that the consultation period had ended on 9th March and HE were in the process of considering responses. A meeting was suggested for a few weeks' time. It was explained that further work was being undertaken regarding the WGAA relocation. Mr O'Reilly asked if HE would fund an agent to represent him which HE will respond to in due course.
04.09.18	Further Consultation	Commencement of further consultation and publication of a scheme layout plan (ref- HE551485-ACM-HGN-M42_SW_ZZ_ZZ-DR-CH-0014), scheme changes plan (ref- HE551485-ACM-HGN-M42_GEN_ZZ_Z-DR-CH-0014) and a redline boundary plan (ref- HE551485-ACM-HGN-M42_GEN_ZZ_Z-DR-CH-0013). Copies of these plans can be found in Appendix B.
21.09.18	Meeting	Mr O'Reilly provided a written list of concerns regarding the scheme. Discussions were formed around the WGAA plans and reasons why relocation of the club was no longer a viable option. Alternative access options were also discussed. Actions from the meeting included the circulation of points of concern articulated by Mr O'Reilly to the wider project team.
30.10.18	Email	Request from Mr O'Reilly for an update on addressing points raised in the meeting of 21.09.18, and an update on options discussed between HE and WGAA.
07.11.18	Email	Response to Mr O'Reilly's email of 30.10.18 with answers to points made by Mr O'Reilly in the meeting on 21.09.18.
13.11.18	Email	Response to HE from Mr O'Reilly regarding the issues from the meeting and a request for information on when drawings will be available for discussion.
21.12.18	Email	Response to Mr O'Reilly's email detailing issues and image of a plan to show what a revised access could look like in detail. A copy of this plan is shown in Appendix A.
	Email	Question from Mr O'Reilly regarding access.
04.01.19	Email	Plan showing a potential revised access to Four Winds shared with Mr O'Reilly.
	Email	Request for dates to arrange meeting with HE.
11.01.19	Email	To arrange meeting with Mr O'Reilly in order to

		give a scheme update on the design and DCO application.
14.01.19	Email	Request from Mr O'Reilly for details of the WGAA options to be forwarded prior to the meeting on 25th January 2019.
25.01.19	Meeting	Meeting to discuss overview of previous communication between the two parties, the proposals for the options being discussed with the WGAA, an update on the DCO application submission and other scheme matters. It was explained to Mr O'Reilly that the provision of option drawings was not practicable until discussions with the WGAA had reached a point whereby a formal layout could be agreed. HE provided a timeline of WGAA proposals. Mr O'Reilly expressed his concerns regarding other elements of the scheme including the air quality and noise concerns due to the proposed new roundabout. Actions arising from the meeting included HE to provide further information relating to the WGAA reconfiguration proposals, the consideration of the appropriateness of HE paying for a professional advisor for Mr O'Reilly, HE to review the rear access proposals and confirmation of noise, air quality monitoring in relation to traffic movements at Barbers Coppice Roundabout and potential lighting impacts on Four Winds.
13.02.19	Email	Request by Mr O'Reilly to Highways England to provide an update on the progress made in regard to the WGAA options.
19.02.19	Email	Mr O'Reilly requesting response to email of 13.02.19
01.03.19	Meeting	Meeting to give an update on the scheme and the DCO application. Discussions also occurred regarding the rear access to the Four Winds property and an A1 drawing showing changes made to the access was provided at the meeting. An update was given regarding the WGAA reconfiguration option and potential impacts on Four Winds. Mr O'Reilly also queried why HE had not yet paid for an advisor for him to which HE explained it does not pay for advisors to object to the scheme. Actions raised from the meeting included HE to provide details of the Option I proposal for the WGAA and investigate the potential of suggestion to the WGAA that they could purchase Four Winds via a joint funding agreement with Highways England.
14.03.19	Email	From Mr O'Reilly requesting an up-to-date drawing of the WGAA proposal ahead of the

		meeting on 28.03.19, clarification on the proposals regarding the new clubhouse and car park for the WGAA, and clarification on the land take acquired for the proposed WGAA options.
19.03.19	Email	Provision of draft WGAA Reconfiguration Option I.
22.03.19	Email	Confirmation of revised access proposals and DCO WGAA proposals.
25.03.19	Email	Mr O'Reilly requesting meeting note from the meeting on 01.03.19. Query as to where to find the WGAA design in the DCO documents. Highways England responded with a reply regarding the location of the DCO plans for the WGAA option.
28.03.19	Meeting	Discussion of suggested design amendments at Four Winds, the WGAA Option I (which was previously shared with Mr O'Reilly and the Parish Council) and explanation that HE is in discussion with the WGAA without prejudice regarding a potential legacy scheme. The potential impacts of the legacy scheme on Four Winds were articulated by Mr O'Reilly. Actions arising from the meeting included providing Mr O'Reilly with a CAD drawing of the suggested design changes and HE to seek advice on whether some payment for an advisor for Mr O'Reilly could be facilitated.
29.03.19	Email	HE circulated the CAD drawing requested by Mr O'Reilly at the meeting on 28.03.19.
01.04.19	Email	From Mr O'Reilly with his mark-up on the CAD drawing provided on 29.03.19 setting out his aspirations for the boundary treatment around Four Winds.
02.04.19	Email	Lands policy response to Mr O'Reilly's additional request for costs – response was no, Highways England does not consider the costs in seeking legal advice in order to raise a representation or objection.
30.04.19	Email	From Mr O'Reilly requesting an update on the actions from the meeting on 28.03.19.
20.05.19	Email	Circulation of meeting minutes and explanation that HE should be in a position to confirm the treatment of any accommodation works around Four Winds within a couple of weeks, dependent on the DCO Examination timetable.



# Appendix A

## Drawings

HE551485-ACM-HML-M42\_ML\_01\_ZZ-SK-CH-0001 – This drawing was provided in an email on 21.12.2018

HE551485-ACM-HML-M42\_ML\_01\_ZZ-SK-CH-0002\_P01 – This drawing was provided at the meeting held in Hampton in Arden on the 25/01/2019

HE551485-ACM-HML-M42\_ML\_01\_ZZ-SK-CH-0002\_P02 – This drawing was provided at the meeting held in Hampton in Arden on the 01/03/2019

HE551485-ACM-GEN-ZZ\_SW\_ZZ\_ZZ-DR-ZH-0109\_P02 – This drawing was provided (marked draft) to Mr O'Reilly on the 19/03/2019 by email.

TR010027\_M42J6\_6-2\_Environmental\_Statement\_Figures\_Figure 3.5 – These are the 5 options assessed as part of the Development Consent Order. These have been in the public realm since the 30<sup>th</sup> January 2019.

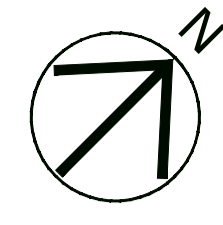

**SAFETY, HEALTH AND ENVIRONMENTAL INFORMATION BOX**

IT IS ASSUMED THAT ALL WORKS ON THIS DRAWING WILL BE CARRIED OUT BY A COMPETENT CONTRACTOR WORKING, WHERE APPROPRIATE, TO AN APPROPRIATE METHOD STATEMENT.

THIS DRAWING IS TO BE USED ONLY FOR THE PURPOSE OF ISSUE THAT IT WAS ISSUED FOR AND IS SUBJECT TO AMENDMENT.

EXCEPTIONAL RISKS RELATING TO THE WORKS ASSOCIATED WITH THIS DRAWING ARE IDENTIFIED BELOW.

**CONSTRUCTION**

MAINTENANCE / OPERATION / DECOMMISSIONING / DEMOLITION

**NOTES**

1. THIS DRAWING IS TO BE READ IN CONJUNCTION WITH ALL OTHER RELEVANT DOCUMENTATION.
2. DO NOT SCALE FROM THIS DRAWING, USE ONLY PRINTED DIMENSIONS.
3. ALL DIMENSIONS IN METRES. ALL CHAINAGES, LEVELS AND COORDINATES ARE IN METRES UNLESS DEFINED OTHERWISE.
4. THIS DRAWING IS TO BE READ IN CONJUNCTION WITH THE PROJECT HEALTH & SAFETY FILE FOR ANY IDENTIFIED POTENTIAL RISKS.

**LEGEND:**

- PROPOSED PMA
- SURFACED CYCLEWAYS & FOOTWAYS
- PROPOSED FOOTWAY
- CENTRAL RESERVES, SPLITTER ISLANDS & OTHER PAVED AREAS
- CARRIAGEWAYS
- UNDERGROUND STORAGE TANK FOR DRAINAGE
- ENVIRONMENTAL MITIGATION
- EMBANKMENT
- VERGES, CUTTINGS

For Information	MA	JF	PO1
Revision Details	By	Check	Date
			Suffix

**FOR INFORMATION**

Client  
Highways England  
Major Projects  
The Cube  
199 Wharfside Street  
Birmingham  
B1 1RN

Working on behalf of  
**highways england**

Project Title  
**M42 JUNCTION 6 IMPROVEMENT**

Drawing Title  
**REVISED ACCESS ARRANGEMENTS FOR FOUR WINDS AND GAA**

Designed TWS	Drawn MA	Checked ME	Approved JF	Date 02/10/18
Internal Project No. 60543032	Suitability S2	Zone M42		
Scale @ A1 1:1000				

THIS DOCUMENT HAS BEEN PREPARED PURSUANT TO AND SUBJECT TO THE TERMS OF AECOM'S APPOINTMENT BY ITS CLIENT. AECOM ACCEPTS NO LIABILITY FOR ANY USE OF THIS DOCUMENT OTHER THAN BY ITS ORIGINAL CLIENT OR FOLLOWING AECOM'S EXPRESS AGREEMENT TO SUCH USE, AND ONLY FOR THE PURPOSES FOR WHICH IT WAS PREPARED AND PROVIDED.

Project Office  
Royal Court  
Basel Close, Chesterfield  
Derbyshire S41 7SL  
Tel(01246) 209221  
Fax(01246) 209229  
www.aecom.com

**AECOM**  
AECOM Infrastructure & Environment UK Limited  
Registered in England Registered number: 880328  
Registered office: Scott House, Alencon Link,  
Basingstoke, Hampshire RG23 7TPP

Drawing Number HE551485	Highways England PIN -ACM	I Originator -HML	I Volume -SK-CH-0001	Rev P01
M42_ML_01_ZZ	-SK-CH-0001	I Type	I Role	I Number

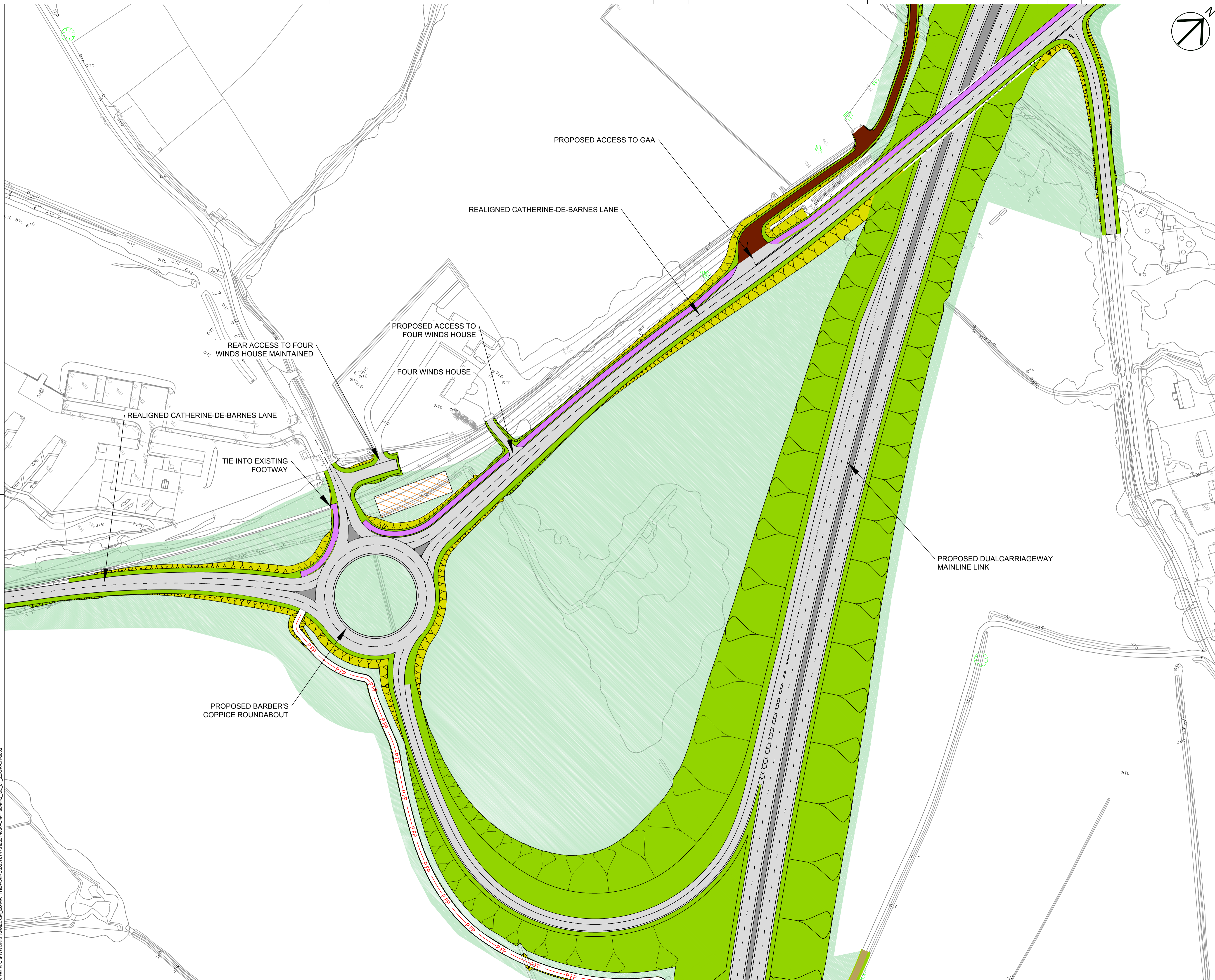

Plot Date: 27 December 2018 15:35:24  
 File Name: C:\P\WORKING\AECOM\EU\MATTHEW\ARD\037677HE551485-ACM-HML-M42\_ML\_01\_ZZ-SK-CH-0002

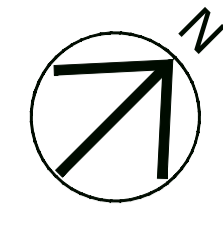

**SAFETY, HEALTH AND ENVIRONMENTAL INFORMATION BOX**

IT IS ASSUMED THAT ALL WORKS ON THIS DRAWING WILL BE CARRIED OUT BY A COMPETENT CONTRACTOR WORKING, WHERE APPROPRIATE, TO AN APPROPRIATE METHOD STATEMENT.

THIS DRAWING IS TO BE USED ONLY FOR THE PURPOSE OF ISSUE THAT IT WAS ISSUED FOR AND IS SUBJECT TO AMENDMENT.

EXCEPTIONAL RISKS RELATING TO THE WORKS ASSOCIATED WITH THIS DRAWING ARE IDENTIFIED BELOW.

**CONSTRUCTION**

MAINTENANCE / OPERATION / DECOMMISSIONING / DEMOLITION

**NOTES**

1. THIS DRAWING IS TO BE READ IN CONJUNCTION WITH ALL OTHER RELEVANT DOCUMENTATION.
2. DO NOT SCALE FROM THIS DRAWING, USE ONLY PRINTED DIMENSIONS.
3. ALL DIMENSIONS IN METRES. ALL CHAINAGES, LEVELS AND COORDINATES ARE IN METRES UNLESS DEFINED OTHERWISE.
4. THIS DRAWING IS TO BE READ IN CONJUNCTION WITH THE PROJECT HEALTH & SAFETY FILE FOR ANY IDENTIFIED POTENTIAL RISKS.

**LEGEND:**

- PROPOSED PMA
- SURFACED CYCLEWAYS & FOOTWAYS
- PROPOSED FOOTWAY
- CENTRAL RESERVES, SPLITTER ISLANDS & OTHER PAVED AREAS
- CARRIAGEWAYS
- UNDERGROUND STORAGE TANK FOR DRAINAGE
- ENVIRONMENTAL MITIGATION
- EMBANKMENT
- VERGES, CUTTINGS

For Information	MA	JF	PO1
Revision Details	By	Check	Date
			Suffix

**FOR INFORMATION**

Client  
Highways England  
Floor 5  
Two Colmore Square  
38 Colmore Circus  
B4 6BN

Working on behalf of  
**highways england**

Project Title  
**M42 JUNCTION 6 IMPROVEMENT**

Drawing Title  
**REVISED ACCESS ARRANGEMENTS FOR FOUR WINDS AND GAA**

Designed TWS	Drawn MA	Checked ME	Approved JF	Date 02/10/18
Internal Project No. 60543032	Suitability S2	Zone M42		
Scale @ A1 1:1000				

THIS DOCUMENT HAS BEEN PREPARED PURSUANT TO AND SUBJECT TO THE TERMS OF AECOM'S APPOINTMENT BY ITS CLIENT. AECOM ACCEPTS NO LIABILITY FOR ANY USE OF THIS DOCUMENT OTHER THAN BY ITS ORIGINAL CLIENT OR FOLLOWING AECOM'S EXPRESS AGREEMENT TO SUCH USE, AND ONLY FOR THE PURPOSES FOR WHICH IT WAS PREPARED AND PROVIDED.

Project Office  
Royal Court  
Basil Close, Chesterfield  
Derbyshire S41 7SL  
Tel(01246) 209221  
Fax(01246) 209229  
www.aecom.com

**AECOM**  
AECOM Infrastructure & Environment UK Limited  
Registered in England Registered number: 880328  
Registered office: Scott House, Alencon Link,  
Basingstoke, Hampshire RG23 7TPP

Drawing Number HE551485	Highways England PIN -ACM	Originator -HML	Volume -SK-CH-0002	Rev P01
M42_ML_01_ZZ	-SK-CH-0002			
Location	Type	Role	Number	

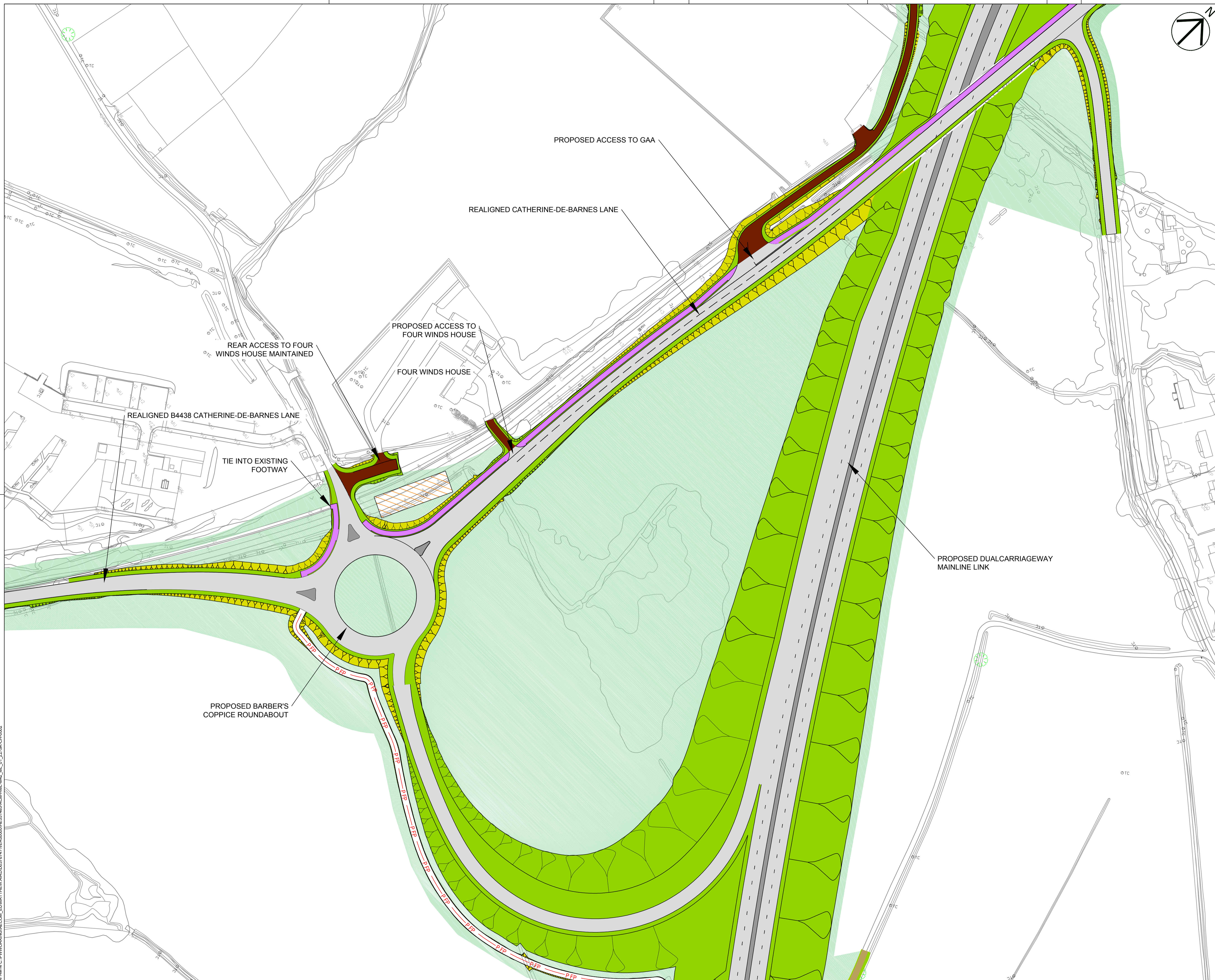

Plot Date: 23 Mar 2018 14:47:28  
 File Name: C:\WORKING\AECOM\EU\MATTHEW\ARD\0376747\VER000\HE551485-ACM-HML\_M42\_ML\_01\_ZZ-SK-CH-0002

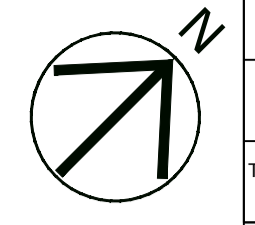
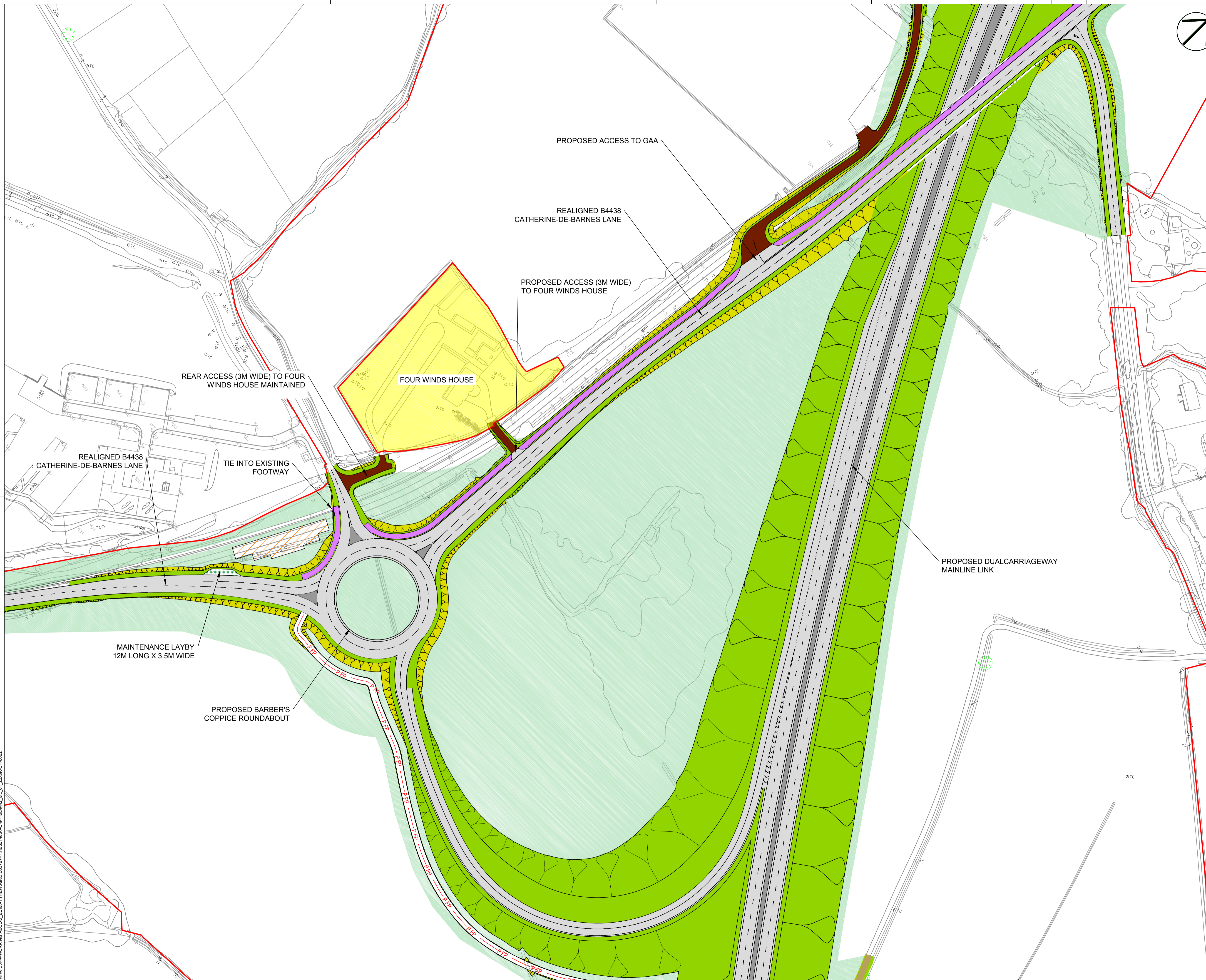

**SAFETY, HEALTH AND ENVIRONMENTAL INFORMATION BOX**  
 IT IS ASSUMED THAT ALL WORKS ON THIS DRAWING WILL BE CARRIED OUT BY A COMPETENT CONTRACTOR WORKING, WHERE APPROPRIATE, TO AN APPROPRIATE METHOD STATEMENT.  
 THIS DRAWING IS TO BE USED ONLY FOR THE PURPOSE OF ISSUE THAT IT WAS ISSUED FOR AND IS SUBJECT TO AMENDMENT.  
 EXCEPTIONAL RISKS RELATING TO THE WORKS ASSOCIATED WITH THIS DRAWING ARE IDENTIFIED BELOW.

**CONSTRUCTION**  
 MAINTENANCE / OPERATION / DECOMMISSIONING / DEMOLITION

**NOTES**  
 1. THIS DRAWING IS TO BE READ IN CONJUNCTION WITH ALL OTHER RELEVANT DOCUMENTATION.  
 2. DO NOT SCALE FROM THIS DRAWING, USE ONLY PRINTED DIMENSIONS.  
 3. ALL DIMENSIONS IN METRES. ALL CHAINAGES, LEVELS AND COORDINATES ARE IN METRES UNLESS DEFINED OTHERWISE.

- LEGEND:**
- LIMITS OF LAND TO BE ACQUIRED OR USED PERMANENTLY OR TEMPORARILY (THE ORDER LIMITS)
  - LAND NOT INCLUDED WITHIN THE ORDER LIMITS
  - CENTRAL RESERVES, SPLITTER ISLANDS & OTHER PAVED AREAS
  - CARRIAGEWAYS
  - PRIVATE MEANS OF ACCESS (PMA)
  - SURFACED CYCLEWAYS & FOOTWAYS
  - PROPOSED FOOTWAY
  - UNDERGROUND STORAGE TANK FOR DRAINAGE
  - ENVIRONMENTAL MITIGATION
  - EMBANKMENT
  - VERGES, CUTTINGS
  - MAINTENANCE LAY-BY

For Information	MA	22/02/19	P02
Revision Details	JF	Date	Suffix
	By		
	Check		

**FOR INFORMATION**  
 Client: Highways England  
 Floor 5  
 Two Colmore Square  
 38 Colmore Circus  
 B4 6BN  
 Working on behalf of **highways england**

Project Title  
**M42 JUNCTION 6 IMPROVEMENT**

Drawing Title  
**REVISED ACCESS ARRANGEMENTS FOR FOUR WINDS AND GAA**

Designed	Drawn	Checked	Approved	Date
EA	MVA	OM	JF	22/02/19
Internal Project No.	Suitability			
60543032	S2			
Scale @ A1	Zone			
1:1000	M42			

THIS DOCUMENT HAS BEEN PREPARED PURSUANT TO AND SUBJECT TO THE TERMS OF AECOM'S APPOINTMENT BY ITS CLIENT. AECOM ACCEPTS NO LIABILITY FOR ANY USE OF THIS DOCUMENT OTHER THAN BY ITS ORIGINAL CLIENT OR FOLLOWING AECOM'S EXPRESS AGREEMENT TO SUCH USE, AND ONLY FOR THE PURPOSES FOR WHICH IT WAS PREPARED AND PROVIDED.

Project Office  
 Royal Court  
 Basil Close, Chesterfield  
 Derbyshire S41 7SL  
 Tel(01246) 209221  
 Fax(01246) 209229  
 www.aecom.com  
**AECOM**  
 AECOM Infrastructure & Environment UK Limited  
 Registered in England Registered number: 880328  
 Registered office: Scott House, Alencon Link,  
 Basingstoke, Hampshire RG23 7TPP

Drawing Number	Highways England PIN	I Originator	I Volume	Rev
HE551485	-ACM	-HML	-	P02
M42_ML_01_ZZ	-SK-CH-0002	I Type	I Role	I Number

Plot Date: 28 February 2019 10:12:28  
 File Name: C:\P\WORKING\AECOM\EU\MATTHEW\ARD\0376747\HE551485-ACM-HML-M42\_ML\_01\_ZZ-SK-CH-0002

THIS MAP IS BASED UPON ORDNANCE SURVEY MATERIAL WITH THE PERMISSION OF ORDNANCE SURVEY ON BEHALF OF THE CONTROLLER OF HER MAJESTY'S STATIONERY OFFICE © CROWN COPYRIGHT. UNAUTHORIZED REPRODUCTION INFRINGES CROWN COPYRIGHT AND MAY LEAD TO PROSECUTION OR CIVIL PROCEEDINGS. HIGHWAYS ENGLAND 100018928/2017

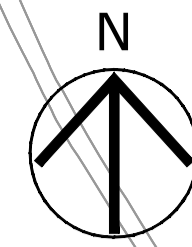

SAFETY, HEALTH AND ENVIRONMENTAL INFORMATION BOX	
IT IS ASSUMED THAT ALL WORKS ON THIS DRAWING WILL BE CARRIED OUT BY A COMPETENT CONTRACTOR WORKING, WHERE APPROPRIATE, TO AN APPROPRIATE METHOD STATEMENT.	
THIS DRAWING IS TO BE USED ONLY FOR THE PURPOSE OF ISSUE THAT IT WAS ISSUED FOR AND IS SUBJECT TO AMENDMENT.	
EXCEPTIONAL RISKS RELATING TO THE WORKS ASSOCIATED WITH THIS DRAWING ARE IDENTIFIED BELOW.	
CONSTRUCTION	
MAINTENANCE / OPERATION / DECOMMISSIONING / DEMOLITION	
NOTES	
	LIMITS OF LAND TO BE ACQUIRED OR USED PERMANENTLY OR TEMPORARILY (THE ORDER LIMITS)
	LAND NOT INCLUDED WITHIN THE ORDER LIMITS
	EXISTING WGAA SITE



NOTES:

- OPTION I - PLOTS 195 / 200 / 210 / 375 / 380
- DIMENSIONS - PITCHES (90mx145m), CLUB HOUSE (60m x 30m)
- SITE AREA - 88,056m<sup>2</sup>

Revision	By	Date	Suffix
First Issue	WC	27/02/19	P01
Second Issue	WC	18/03/19	P02
Revision Details	By	Date	Suffix
	Check		

Purpose of Issue: FOR INFORMATION

Client: Highways England  
 Floor 5  
 Two Colmore Square  
 38 Colmore Circus  
 B4 6BN

Working on behalf of

Project Title: M42 JUNCTION 6 IMPROVEMENT

Drawing Title: POTENTIAL WGAA RECONFIGURATION OPTION I

**DRAFT**

Designed: CW	Drawn: WC	Checked: JCH	Approved: IJB	Date: 18/03/19
Internal Project No: 60543032	Suitability: S2	Zone: Scheme Wide General		
Scale @ A1: 1:2000	THIS DOCUMENT HAS BEEN PREPARED PURSUANT TO AND SUBJECT TO THE TERMS OF AECOM'S APPOINTMENT BY ITS CLIENT. AECOM ACCEPTS NO LIABILITY FOR ANY USE OF THIS DOCUMENT OTHER THAN BY ITS ORIGINAL CLIENT OR FOLLOWING AECOM'S EXPRESS AGREEMENT TO SUCH USE, AND ONLY FOR THE PURPOSES FOR WHICH IT WAS PREPARED AND PROVIDED.			

**AECOM**  
 Royal Court  
 Basil Close  
 Chesterfield  
 Tel: 01246 209221  
 Fax: 01246 209229  
 www.aecom.com

Registered in England Registered number: 880328  
 Registered office: Midpoint, Alconon Link,  
 Basingstoke, Hampshire RG21 7FP

Drawing Number: HE551485	Originator: -ACM	Volume: -GEN-	Rev: P02
Location: ZZ_SW_ZZ_ZZ	Issue: -DR-ZH-0109	Role: I Number:	

Plot Date: 18 March 2019 09:18:44  
 File Name: C:\PWORKING\AECOM\EJAMES\HEINING\WYD0377\59HE551485-ACM-GEN-ZZ\_SW\_ZZ\_DR-ZH-0109



NOTES  
THIS DRAWING IS TO BE READ IN CONJUNCTION WITH ALL OTHER RELEVANT DOCUMENTATION.



FIRST ISSUE	GB	JG	12/12/18	C01
Revision Details	By	Check	Date	Suffix

Purpose of Issue  
**DCO SUBMISSION**

Client  
Highways England  
Floor 5  
Two Colmore Square  
38 Colmore Circus  
B4 6BN



Development Consent Order Number  
**TR010027**

Project Title  
**M42 JUNCTION 6 IMPROVEMENT**

Drawing Title  
**FIGURE 3.5A WARWICKSHIRE GAELIC ATHLETIC ASSOCIATION OPTION 1**

Designed JH	Drawn GB	Checked JG	Approved JG	Date 12/12/18
Internal Project No 60543032		Suitability D7		
Scale @ A3 NTS		Zone M42		

THIS DOCUMENT HAS BEEN PREPARED PURSUANT TO AND SUBJECT TO THE TERMS OF AECOM'S APPOINTMENT BY ITS CLIENT. AECOM ACCEPTS NO LIABILITY FOR ANY USE OF THIS DOCUMENT OTHER THAN BY ITS ORIGINAL CLIENT OR FOLLOWING AECOM'S EXPRESS AGREEMENT TO SUCH USE, AND ONLY FOR THE PURPOSES FOR WHICH IT WAS PREPARED AND PROVIDED.

Drawing Number HE551485	Highways England Pn -ACM	Originator -EGN-	Volume -DR-DC-0245	Rev C01
Location M42_SW_ZZ_ZZ				Type   Role   Number

Filename: K:\GIS Management\60543032 - M42 Jct 6 GIS Folder\_GIS01\_Maps\00\_Figures\New Template\FIGURE 3.5.mxd



NOTES  
THIS DRAWING IS TO BE READ IN CONJUNCTION WITH ALL OTHER RELEVANT DOCUMENTATION.



EXISTING GAA CLUBHOUSE TO BE DEMOLISHED

EXISTING PITCH TO BE MAINTAINED

PROPOSED MEMORIAL GARDEN

HURLING WALL

SPORTING PITCH

SPORTING PITCH

SPORTING PITCH

CAR PARK

UPGRADED ACCESS

FOUR WINDS

PROPOSED GAA PITCH POSITIONED ON ESSO FUEL LINE, BUILD OVER LICENSE SHALL NEED TO BE AGREED. ESSO WILL REQUIRE ACCESS FOR ROUTINE INSPECTION AND ANY MAINTENANCE REQUIRED

NEW CLUB HOUSE TO BE PROVIDED. SPECIFICATION TO BE AGREED

FIRST ISSUE	GB	JG	12/12/18	C01
Revision Details	By	Check	Date	Suffix

Purpose of Issue  
**DCO SUBMISSION**

Client  
Highways England  
Floor 5  
Two Colmore Square  
38 Colmore Circus  
B4 6BN



Development Consent Order Number  
**TR010027**

Project Title  
**M42 JUNCTION 6 IMPROVEMENT**

Drawing Title  
**FIGURE 3.5B WARWICKSHIRE GAAELIC ATHLETIC ASSOCIATION OPTION 2**

Designed JH	Drawn GB	Checked JG	Approved JG	Date 12/12/18
Internal Project No 60543032			Suitability D7	
Scale @ A3 NTS		Zone M42		

THIS DOCUMENT HAS BEEN PREPARED PURSUANT TO AND SUBJECT TO THE TERMS OF AECOM'S APPOINTMENT BY ITS CLIENT. AECOM ACCEPTS NO LIABILITY FOR ANY USE OF THIS DOCUMENT OTHER THAN BY ITS ORIGINAL CLIENT OR FOLLOWING AECOM'S EXPRESS AGREEMENT TO SUCH USE, AND ONLY FOR THE PURPOSES FOR WHICH IT WAS PREPARED AND PROVIDED.

Drawing Number HE551485 -ACM -EGN-	Originator -ACM	Volume -EGN-	Rev C01
Location M42_SW_ZZ_ZZ		Type   Role   Number -DR-DC-0246	

Filename: K:\GIS Management\60543032 - M42 Jct 6 GIS Folder\_GIS01\_Figures\New Template\Figure 3.5.mxd



NOTES  
THIS DRAWING IS TO BE READ IN CONJUNCTION WITH ALL OTHER RELEVANT DOCUMENTATION.



FIRST ISSUE	GB	JG	12/12/18	C01
Revision Details	By	Check	Date	Suffix

Purpose of Issue  
**DCO SUBMISSION**

Client  
Highways England  
Floor 5  
Two Colmore Square  
38 Colmore Circus  
B4 6BN



Development Consent Order Number  
**TR010027**

Project Title  
**M42 JUNCTION 6 IMPROVEMENT**

Drawing Title  
**FIGURE 3.5C  
WARWICKSHIRE  
GAELIC ATHLETIC ASSOCIATION  
OPTION 3**

Designed JH	Drawn GB	Checked JG	Approved JG	Date 12/12/18
Internal Project No 60543032			Suitability D7	
Scale @ A3 NTS			Zone M42	

THIS DOCUMENT HAS BEEN PREPARED PURSUANT TO AND SUBJECT TO THE TERMS OF AECOM'S APPOINTMENT BY ITS CLIENT. AECOM ACCEPTS NO LIABILITY FOR ANY USE OF THIS DOCUMENT OTHER THAN BY ITS ORIGINAL CLIENT OR FOLLOWING AECOM'S EXPRESS AGREEMENT TO SUCH USE, AND ONLY FOR THE PURPOSES FOR WHICH IT WAS PREPARED AND PROVIDED.

Drawing Number HE551485	Originator -ACM	Volume -EGN-	Rev C01
Location M42_SW_ZZ_ZZ		Type   Role   Number -DR-DC-0247	

Filename: K:\GIS Management\60543032 - M42 Jct 6 GIS Folder\_GIS01\_Figures\New Template\Figure 3.5.mxd





NOTES  
THIS DRAWING IS TO BE READ IN CONJUNCTION WITH ALL OTHER RELEVANT DOCUMENTATION.



FIRST ISSUE	GB	JG	12/12/18	C01
Revision Details	By	Check	Date	Suffix

Purpose of Issue  
**DCO SUBMISSION**

Client  
Highways England  
Floor 5  
Two Colmore Square  
38 Colmore Circus  
B4 6BN



Development Consent Order Number  
**TR010027**

Project Title  
**M42 JUNCTION 6 IMPROVEMENT**

Drawing Title  
**FIGURE 3.5D WARWICKSHIRE GAELIC ATHLETIC ASSOCIATION OPTION 4**

Designed JH	Drawn GB	Checked JG	Approved JG	Date 12/12/18
Internal Project No 60543032			Suitability D7	
Scale @ A3 NTS		Zone M42		

THIS DOCUMENT HAS BEEN PREPARED PURSUANT TO AND SUBJECT TO THE TERMS OF AECOM'S APPOINTMENT BY ITS CLIENT. AECOM ACCEPTS NO LIABILITY FOR ANY USE OF THIS DOCUMENT OTHER THAN BY ITS ORIGINAL CLIENT OR FOLLOWING AECOM'S EXPRESS AGREEMENT TO SUCH USE, AND ONLY FOR THE PURPOSES FOR WHICH IT WAS PREPARED AND PROVIDED.

Drawing Number HE551485 -ACM	Originator -EGN-	Volume -EGN-	Rev C01
Location M42_SW_ZZ_ZZ		Type   Role   Number -DR-DC-0248	

Filename: K:\GIS Management\60543032 - M42 Jct 6 GIS folder\_GIS01\_Maps\100\_Figures\New Template\FIGURE 3.5.mxd



NOTES  
THIS DRAWING IS TO BE READ IN CONJUNCTION WITH ALL OTHER RELEVANT DOCUMENTATION.



PROPOSED GAA PITCH POSITIONED ON ESSO FUEL LINE, BUILD OVER LICENSE SHALL NEED TO BE AGREED, ESSO SHALL REQUIRE ACCESS FOR ROUTINE INSPECTION AND MAINTENANCE

FIRST ISSUE	GB	JG	12/12/18	C01
Revision Details	By	Check	Date	Suffix

Purpose of Issue  
**DCO SUBMISSION**

Client  
Highways England  
Floor 5  
Two Colmore Square  
38 Colmore Circus  
B4 6BN



Development Consent Order Number  
**TR010027**

Project Title  
**M42 JUNCTION 6 IMPROVEMENT**

Drawing Title  
**FIGURE 3.5E WARWICKSHIRE GAELIC ATHLETIC ASSOCIATION OPTION 5**

Designed JH	Drawn GB	Checked JG	Approved JG	Date 12/12/18
Internal Project No 60543032			Suitability D7	
Scale @ A3 NTS		Zone M42		

THIS DOCUMENT HAS BEEN PREPARED PURSUANT TO AND SUBJECT TO THE TERMS OF AECOM'S APPOINTMENT BY ITS CLIENT. AECOM ACCEPTS NO LIABILITY FOR ANY USE OF THIS DOCUMENT OTHER THAN BY ITS ORIGINAL CLIENT OR FOLLOWING AECOM'S EXPRESS AGREEMENT TO SUCH USE, AND ONLY FOR THE PURPOSES FOR WHICH IT WAS PREPARED AND PROVIDED.

Drawing Number HE551485	Highways England Pn -ACM	Originator -EGN-	Volume -DR-DC-0249	Rev C01
Location M42_SW_ZZ_ZZ		Type   Role   Number		

Filename: K:\GIS Management\60543032 - M42 Jct 6 GIS Folder\_GIS01\_Maps\100\_Figures\New Template\FIGURE 3.5.mxd

## Appendix B

### Drawings made publically available during Stage 3

The following are drawings that have been made publically available during Stage 3 in respect to Statutory and Further Statutory Consultation Events.

HE551485-ACM-HGN-M42\_SW\_ZZ\_ZZ-DR-CH-0020 – Layout plan published on M42 J6 Statutory Consultation webpage on the 09/01/2018

HE551485-ACM-HGN-M42\_SW\_ZZ\_ZZ-DR-CH-0014 – Coloured Layout plan published on the M42 J6 Further Statutory Consultation webpage on the 04/09/2018

HE551485-ACM-HGN-M42\_GEN\_ZZ\_Z-DR-CH-0014 – Scheme Changes Plan published on the M42 J6 Further Statutory Consultation webpage on the 04/09/2018

HE551485-ACM-HGN-M42\_GEN\_ZZ\_Z-DR-CH-0013 – Redline boundary plan published on the M42 J6 Further Statutory Consultation webpage on the 04/09/2018

This map is based upon Ordnance Survey material with the permission of Ordnance Survey on behalf of the Controller of Her Majesty's Stationery Office © Crown copyright. Unauthorised reproduction infringes Crown copyright and may lead to prosecution or civil proceedings. Highways England 100030649 2018

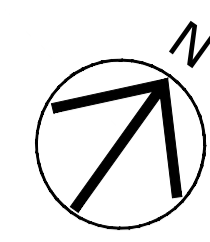

**SAFETY, HEALTH AND ENVIRONMENTAL INFORMATION BOX**

IT IS ASSUMED THAT ALL WORKS ON THIS DRAWING WILL BE CARRIED OUT BY A COMPETENT CONTRACTOR WORKING, WHERE APPROPRIATE, TO AN APPROPRIATE METHOD STATEMENT.  
THIS DRAWING IS TO BE USED ONLY FOR THE PURPOSE OF ISSUE THAT IT WAS ISSUED FOR AND IS SUBJECT TO AMENDMENT.  
EXCEPTIONAL RISKS RELATING TO THE WORKS ASSOCIATED WITH THIS DRAWING ARE IDENTIFIED BELOW.

**CONSTRUCTION**

MAINTENANCE / OPERATION / DECOMMISSIONING / DEMOLITION

**NOTES**

1. THIS DRAWING IS TO BE READ IN CONJUNCTION WITH ALL OTHER RELEVANT DOCUMENTATION.
2. DO NOT SCALE FROM THIS DRAWING. USE ONLY PRINTED DIMENSIONS.
3. ALL DIMENSIONS IN MILLIMETRES. ALL CHAINAGES, LEVELS AND COORDINATES ARE IN METRES UNLESS DEFINED OTHERWISE.
4. THIS DRAWING IS TO BE READ IN CONJUNCTION WITH THE PROJECT HEALTH & SAFETY FILE FOR ANY IDENTIFIED POTENTIAL RISKS.

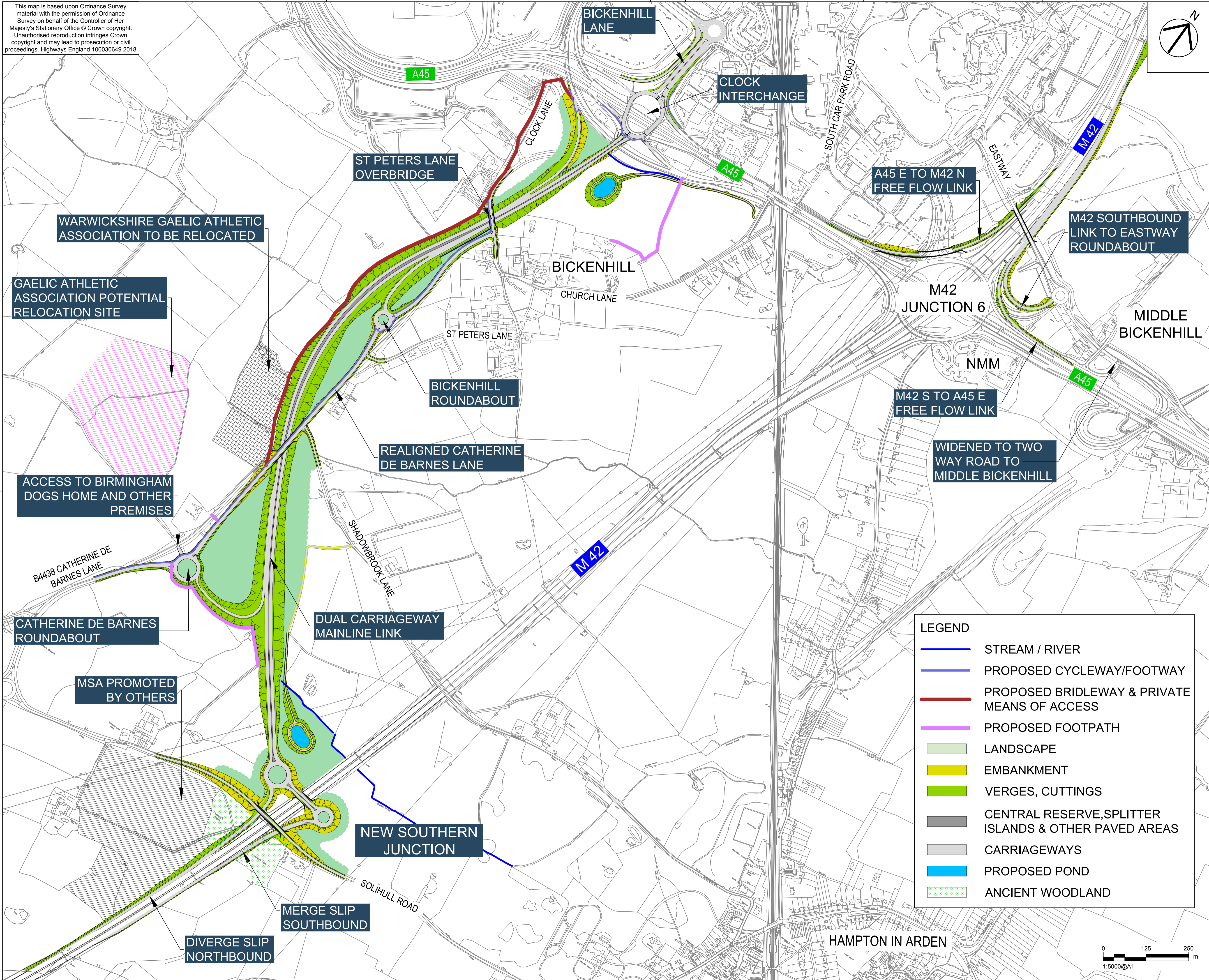

**LEGEND**

- STREAM / RIVER
- PROPOSED CYCLEWAY/FOOTWAY
- PROPOSED BRIDLEWAY & PRIVATE MEANS OF ACCESS
- PROPOSED FOOTPATH
- LANDSCAPE
- EMBANKMENT
- VERGES, CUTTINGS
- CENTRAL RESERVE, SPLITTER ISLANDS & OTHER PAVED AREAS
- CARRIAGEWAYS
- PROPOSED POND
- ANCIENT WOODLAND

Revision 1 Details			
By	Check	Date	Suffix
		15/01/18	P01.1

**INITIAL STATUS OR WIP**

Client: Highways England  
The Cube, 199 Wharfside Street, Birmingham B1 1RN  
Project Title: M42 JUNCTION 6 IMPROVEMENTS

**M42 JUNCTION 6 COLOURED HATCH SCHEME WIDE SHEET 1 OF 1**

Designed	Drawn	Checked	Approved	Date
AL				

Internal Project No. 60543032  
Scale @ A1 1:5000  
Zone M42  
Suitability S0

THIS DOCUMENT HAS BEEN PREPARED PURSUANT TO AND SUBJECT TO THE TERMS OF AECOM'S APPOINTMENT BY ITS CLIENT. AECOM ACCEPTS NO LIABILITY FOR ANY USE OF THIS DOCUMENT OTHER THAN BY ITS ORIGINAL CLIENT OR FOLLOWING AECOM'S EXPRESS AGREEMENT TO SUCH USE, AND ONLY FOR THE PURPOSES FOR WHICH IT WAS PREPARED AND PROVIDED.

Drawing Number	Highways England PIN	1 Originator	1 Volume	Rev
HE551485 -ACM				P01.1
M42_SW_ZZ_ZZ				
Location		I Type	I Role	I Number



This map is based upon Ordnance Survey material with the permission of Ordnance Survey on behalf of the Controller of Her Majesty's Stationery Office © Crown copyright. Unauthorised reproduction infringes Crown copyright and may lead to prosecution or civil proceedings. Highways England 100030649 2018

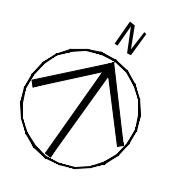

**SAFETY, HEALTH AND ENVIRONMENTAL INFORMATION BOX**

IT IS ASSUMED THAT ALL WORKS ON THIS DRAWING WILL BE CARRIED OUT BY A COMPETENT CONTRACTOR WORKING UNDER APPROPRIATE, TO AN APPROPRIATE METHOD STATEMENT.

THIS DRAWING IS TO BE USED ONLY FOR THE PURPOSE OF ISSUE THAT IT WAS ISSUED FOR AND IS SUBJECT TO AMENDMENT.

EXCEPTIONAL RISKS RELATING TO THE WORKS ASSOCIATED WITH THIS DRAWING ARE IDENTIFIED BELOW.

**CONSTRUCTION**

**MAINTENANCE / OPERATION / DECOMMISSIONING / DEMOLITION**

**NOTES**

- THIS DRAWING IS TO BE READ IN CONJUNCTION WITH ALL OTHER RELEVANT DOCUMENTATION.
- DO NOT SCALE FROM THIS DRAWING. USE ONLY PRINTED DIMENSIONS.
- ALL DIMENSIONS IN MILLIMETRES. ALL CHANGES, LEVELS AND COORDINATES ARE IN METRES UNLESS DEFINED OTHERWISE.
- THIS DRAWING IS TO BE READ IN CONJUNCTION WITH THE PROJECT HEALTH & SAFETY FILE FOR ANY IDENTIFIED POTENTIAL RISKS.

**LEGEND**

- GMT — EXISTING GREEN MAN TRAIL
- ACR — EXISTING CYCLEWAY
- BW — EXISTING BRIDLEWAY
- FP — EXISTING FOOTPATH
- FWCW — EXISTING CYCLEWAY/FOOTWAY
- DCR — EXISTING DEDICATED CYCLE ROUTE
- — EXTENT OF SCHEME
- — ROAD SIGN LOCATIONS
- — PROPOSED BRIDLEWAY & PRIVATE MEANS OF ACCESS
- — PROPOSED FOOTPATH
- — PROPOSED CYCLEWAY/FOOTWAY
- — PROPOSED FOOTWAY
- — PROPOSED GREEN MAN TRAIL
- X — X — STOP UP
- — STREAM / RIVER
- — DRAINAGE SWALE
- — DRAINAGE CARRIER
- — DRAINAGE DITCH
- — PROPOSED LANDSCAPE SCREENING AND BIODIVERSITY MITIGATION
- — EMBANKMENT
- — VERGES, CUTTINGS
- — CENTRAL RESERVE, SPLITTER ISLANDS & OTHER PAVED AREAS
- — CARRIAGEWAYS
- — ACCESS TRACK
- — REED BEDS
- — ANCIENT WOODLAND
- — AREA EXCLUDED FROM RED LINE BOUNDARY
- — UNDERGROUND STORAGE TANK FOR DRAINAGE
- — STRUCTURE
- — EXISTING WARWICKSHIRE GAELIC ATHLETIC ASSOCIATION SITE
- — INDICATIVE AREA OF SEARCH TO FACILITATE PROPORTIONATE RECONFIGURATION OF THE WARWICKSHIRE GAELIC ATHLETIC ASSOCIATION SITE REQUIRED FOR THE SCHEME

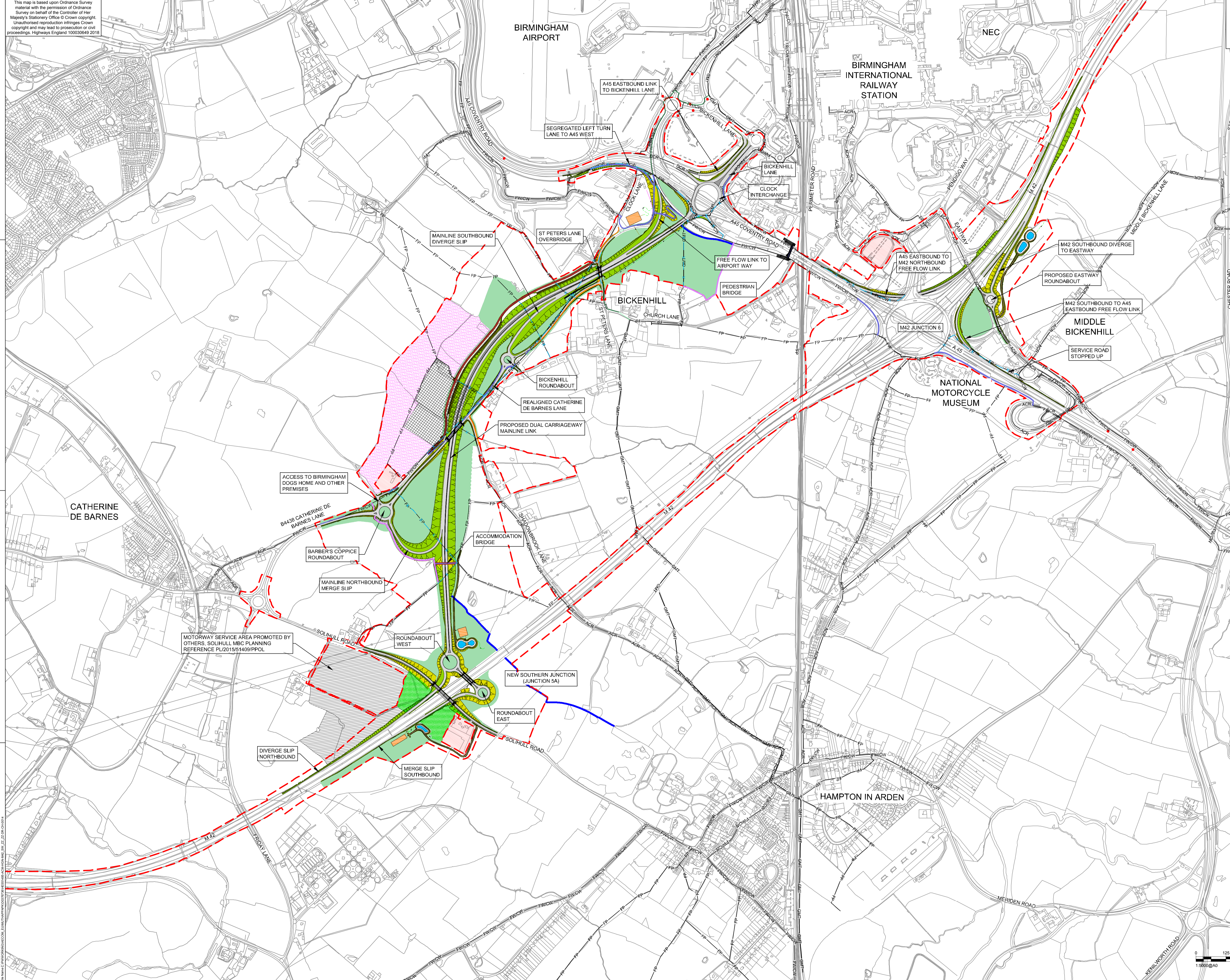

First Issue	PK	PK	PK	PK	PK

**FOR INFORMATION**

Client: Highways England  
 Working on behalf of: highways england

Project Title: **M42 JUNCTION 6 IMPROVEMENTS**

**M42 JUNCTION 6 COLOURED SCHEME PLAN**

Designed	Drawn	Checked	Approved	Date
PKR	RKR	JF	JF	04/09/18

Formal Project No: 6554/032  
 Scale @ A0: 1:5000

**AECOM**  
 Project: HE551485 - ACM - HGN - M42 SW ZZ ZZ  
 Drawing: DR CH 0014  
 Issue: P04

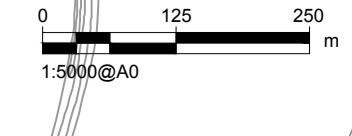

This map is based upon Ordnance Survey material with the permission of Ordnance Survey on behalf of the Controller of Her Majesty's Stationery Office © Crown copyright. Unauthorised reproduction infringes Crown copyright and may lead to prosecution or civil proceedings. Highways England 100030649 2018

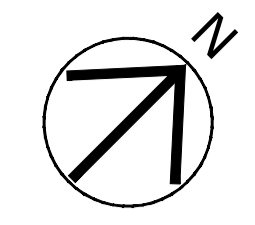

**SAFETY, HEALTH AND ENVIRONMENTAL INFORMATION BOX**  
 IT IS ASSUMED THAT ALL WORKS ON THIS DRAWING WILL BE CARRIED OUT BY A COMPETENT CONTRACTOR WORKING, WHERE APPROPRIATE, TO AN APPROPRIATE METHOD STATEMENT.  
 THIS DRAWING IS TO BE USED ONLY FOR THE PURPOSE OF ISSUE THAT IT WAS ISSUED FOR AND IS SUBJECT TO AMENDMENT.  
 EXCEPTIONAL RISKS RELATING TO THE WORKS ASSOCIATED WITH THIS DRAWING ARE IDENTIFIED BELOW.

**CONSTRUCTION**

**MAINTENANCE / OPERATION / DECOMMISSIONING / DEMOLITION**

- NOTES**
1. THIS DRAWING IS TO BE READ IN CONJUNCTION WITH ALL OTHER RELEVANT DOCUMENTATION.
  2. DO NOT SCALE FROM THIS DRAWING, USE ONLY PRINTED DIMENSIONS.
  3. ALL DIMENSIONS IN METRES. ALL CHAINAGES, LEVELS AND COORDINATES ARE IN METRES UNLESS DEFINED OTHERWISE.
  4. THIS DRAWING IS TO BE READ IN CONJUNCTION WITH THE PROJECT HEALTH & SAFETY FILE FOR ANY IDENTIFIED POTENTIAL RISKS.

- LEGEND**
- PROPOSED DESIGN
  - - - - - EXTENT OF SCHEME
  - ROAD SIGN LOCATIONS
  - AREA EXCLUDED FROM SCHEME EXTENTS
  - NMM/NCC NATIONAL MOTORCYCLE MUSEUM/ NATIONAL CONFERENCE CENTRE
  - NEC NATIONAL EXHIBITION CENTRE
  - 1 DESIGN CHANGE IN ACCORDANCE WITH CONSULTATION LETTER ANNEX

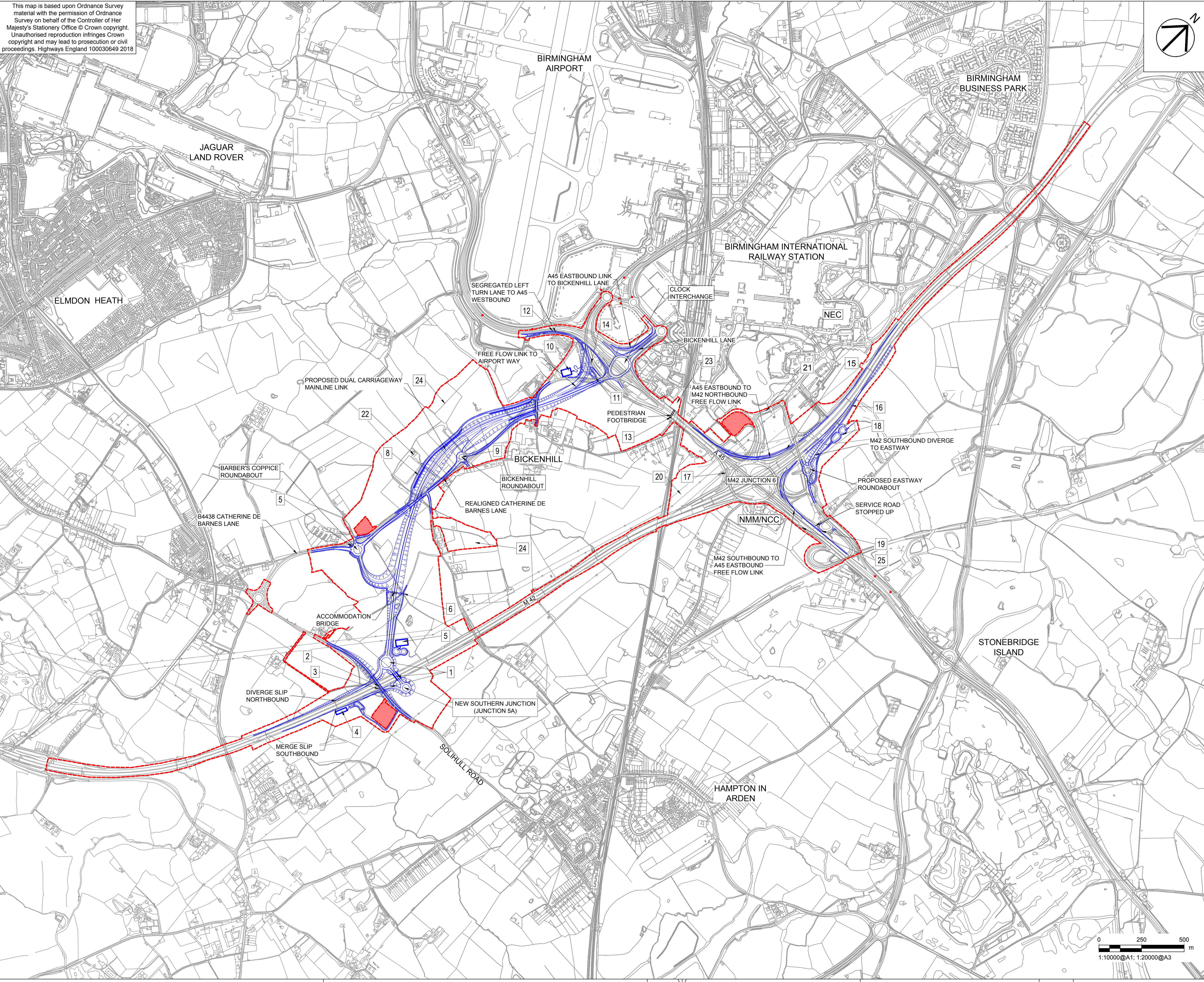

First Issue	MWA	28/08/18	P02
Revision Details	By	Date	Suffix
	JF		
	Check		

**FOR INFORMATION**

Client: Highways England  
 The Cube  
 199 Wharfside Street  
 Birmingham  
 B1 1RN

Working on behalf of

Project Title  
**M42 JUNCTION 6 IMPROVEMENTS**

Drawing Title  
**M42 JUNCTION 6 SCHEME CHANGES AND DESIGN DEVELOPMENT**

Designed	Drawn	Checked	Approved	Date
JCH	MWA	OM	JF	28/08/18
Internal Project No.	Suitability			
60543032	S2			
Scale @ A1	Zone			
1:10000	M42			

THIS DOCUMENT HAS BEEN PREPARED PURSUANT TO AND SUBJECT TO THE TERMS OF AECOM'S APPOINTMENT BY ITS CLIENT. AECOM ACCEPTS NO LIABILITY FOR ANY USE OF THIS DOCUMENT OTHER THAN BY ITS ORIGINAL CLIENT OR FOLLOWING AECOM'S EXPRESS AGREEMENT TO SUCH USE, AND ONLY FOR THE PURPOSES FOR WHICH IT WAS PREPARED AND PROVIDED.

AECOM  
 Royal Court  
 Basil Close  
 Chesterfield  
 Tel: 01246 209221  
 Fax: 01246 209229  
 www.aecom.com

**AECOM**  
 AECOM Infrastructure & Environment UK Limited  
 Registered in England Registered number: 880328  
 Registered office: Scott House, Alencon Link,  
 Basingstoke, Hampshire RG21 7PZ

Drawing Number	1 Originator	1 Volume	Rev
HE551485	-ACM	-HGN-	P02
M42_GEN_ZZ_ZZ	-DR-CH-0014		
Location	1 Type	1 Role	1 Number

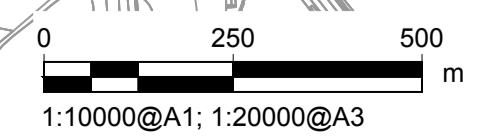

File Name: C:\P\WORKING\AECOM\EU\MATTHEW\ARDON\081767\HE551485-ACH-HGN-M42\_GEN\_ZZ\_ZZ-DR-CH-0014  
 Plot Date: 28/08/18 15:03:33

This map is based upon Ordnance Survey material with the permission of Ordnance Survey on behalf of the Controller of Her Majesty's Stationery Office © Crown copyright. Unauthorised reproduction infringes Crown copyright and may lead to prosecution or civil proceedings. Highways England 100030649 2018

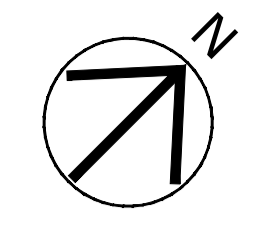

**SAFETY, HEALTH AND ENVIRONMENTAL INFORMATION BOX**  
 IT IS ASSUMED THAT ALL WORKS ON THIS DRAWING WILL BE CARRIED OUT BY A COMPETENT CONTRACTOR WORKING, WHERE APPROPRIATE, TO AN APPROPRIATE METHOD STATEMENT.  
 THIS DRAWING IS TO BE USED ONLY FOR THE PURPOSE OF ISSUE THAT IT WAS ISSUED FOR AND IS SUBJECT TO AMENDMENT.  
 EXCEPTIONAL RISKS RELATING TO THE WORKS ASSOCIATED WITH THIS DRAWING ARE IDENTIFIED BELOW.

**CONSTRUCTION**

**MAINTENANCE / OPERATION / DECOMMISSIONING / DEMOLITION**

- NOTES**
1. THIS DRAWING IS TO BE READ IN CONJUNCTION WITH ALL OTHER RELEVANT DOCUMENTATION.
  2. DO NOT SCALE FROM THIS DRAWING, USE ONLY PRINTED DIMENSIONS.
  3. ALL DIMENSIONS IN METRES. ALL CHAINAGES, LEVELS AND COORDINATES ARE IN METRES UNLESS DEFINED OTHERWISE.
  4. THIS DRAWING IS TO BE READ IN CONJUNCTION WITH THE PROJECT HEALTH & SAFETY FILE FOR ANY IDENTIFIED POTENTIAL RISKS.
  5. ALL ACCOMMODATION TRACKS AND DETENTION BASIN ACCESS TRACKS ARE INDICATIVE ONLY AT THIS STAGE.

- LEGEND**
- PROPOSED DESIGN
  - - - - - EXTENT OF SCHEME
  - ROAD SIGN LOCATIONS
  - AREA EXCLUDED FROM EXTENT OF SCHEME
  - NMM/NCC** NATIONAL MOTORCYCLE MUSEUM / NATIONAL CONFERENCE CENTRE
  - NEC** NATIONAL EXHIBITION CENTRE

First Issue	MWA	28/08/18	P03
Revision Details	By	Date	Suffix
	JF		
	Check		

**FOR INFORMATION**

Client: Highways England  
 The Cube  
 199 Wharfside Street  
 Birmingham  
 B1 1RN  
 0

Project Title

**M42 JUNCTION 6 IMPROVEMENTS**

**M42 JUNCTION 6 REDLINE BOUNDARY PLAN**

Designed	Drawn	Checked	Approved	Date
JCH	MWA	OM	JF	28/08/18
Internal Project No.	Suitability			
60543032	S2			
Scale @ A1	Zone			
1:10000	M42			

THIS DOCUMENT HAS BEEN PREPARED PURSUANT TO AND SUBJECT TO THE TERMS OF AECOM'S APPOINTMENT BY ITS CLIENT. AECOM ACCEPTS NO LIABILITY FOR ANY USE OF THIS DOCUMENT OTHER THAN BY ITS ORIGINAL CLIENT OR FOLLOWING AECOM'S EXPRESS AGREEMENT TO SUCH USE, AND ONLY FOR THE PURPOSES FOR WHICH IT WAS PREPARED AND PROVIDED.

**AECOM**  
 Royal Court  
 Basil Close  
 Chesterfield  
 Tel: 01246 209221  
 Fax: 01246 209229  
 www.aecom.com

**AECOM Infrastructure & Environment UK Limited**  
 Registered in England Registered number: 880328  
 Registered office: Scott House, Alencon Link,  
 Basingstoke, Hampshire RG21 7PZ

Drawing Number	1 Originator	1 Volume	Rev
HE551485 - ACM	- HGN -		P03
M42_GEN_ZZ_ZZ	- DR-CH-0013		
Location	1 Type	1 Role	1 Number

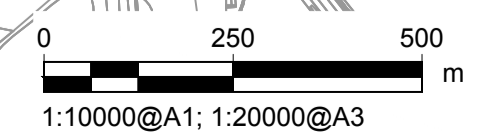
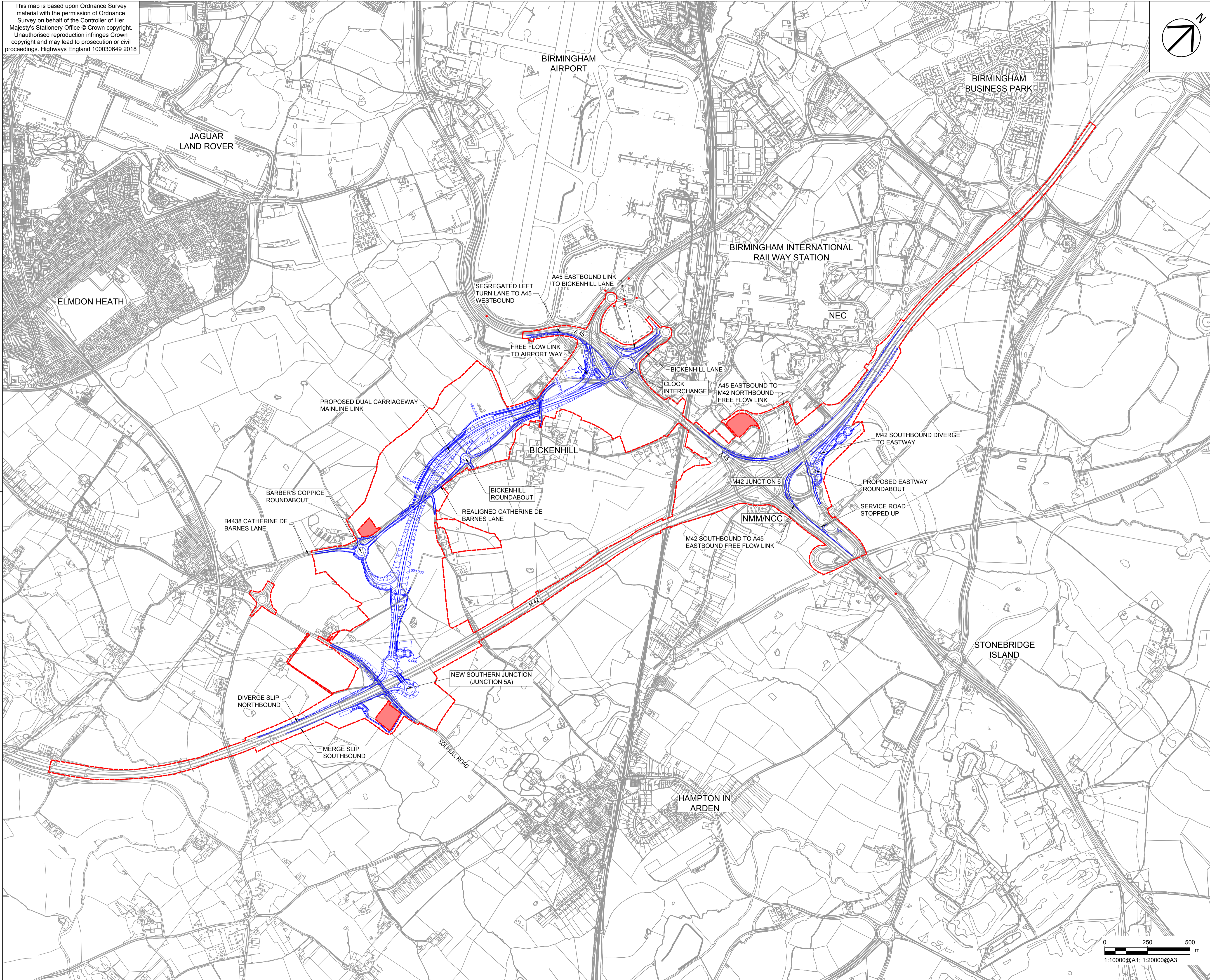

File Name: C:\WORKING\AECOM\EU\WATTHEW\ARDEN\081707\HE551485-ACH-HGN-M42\_GEN\_ZZ\_ZZ-DR-CH-0013  
 Plot Date: 28 August 2018 15:20:11